



5 Coachella Crescent Upper Coomera QLD

4  2  2 

Easy living in this modern family home.

This immaculate home is located in the sought-after Highland Reserve Estate.

The home provides family comfort with the separate lounge and dining and media room areas, as well as quality fittings and fixtures throughout.

The kitchen exudes elegance with 70mm stone bench tops, gas cook top, double under-slung Oliveri sink and a plumbed fridge cavity.

The tiled family/dining room flows out to the ultimate entertaining area with large deck, servery, mood lighting and ceiling fans.

Price : \$820 pw
Building Size : 150 sqm
Land Size : 579 sqm
View : <https://www.hinterlandrealty.com/81548>
 50



Lauren Johnson
 07 5578 2311



Chloe Flack
 07 5578 2311

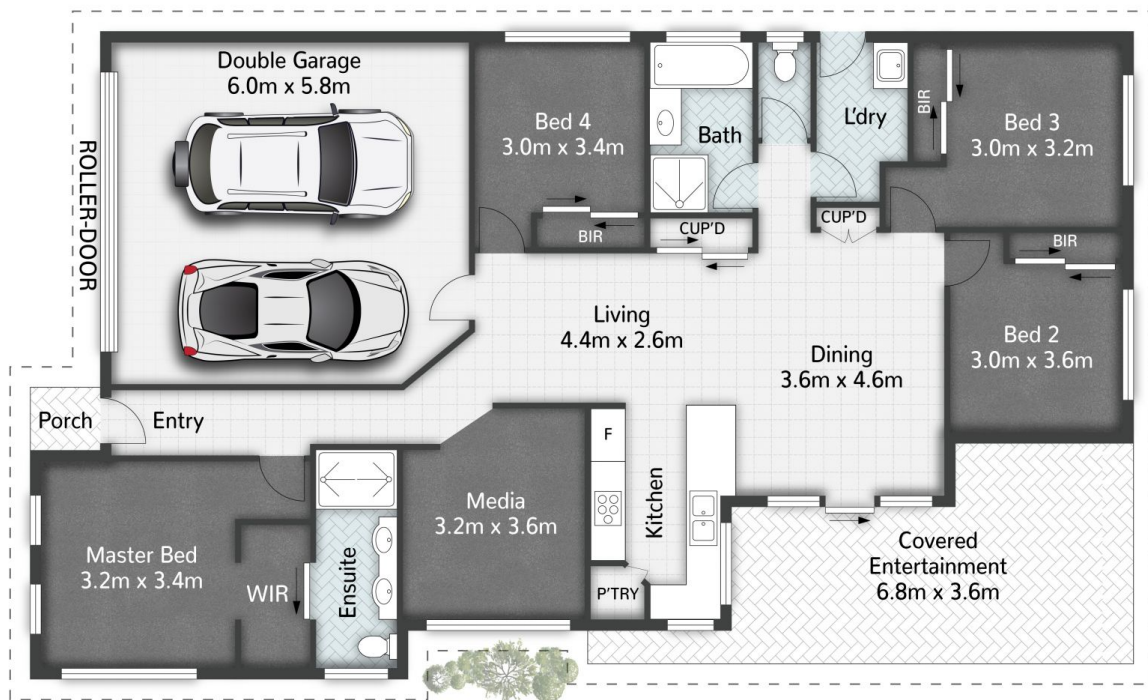

Plans are shown for marketing purposes only. All dimensions are approximate; they are subject to errors and inaccuracies and no liability will be accepted.